



Technical specifications

Q-Perimeter Lights

Light Color:	White
Light Source:	LED
IP-Index:	IP67
Enclosure:	Aluminium, powder coated
Dimensions:	18 x 16 x 24 cm (L x W x H)
Mounting:	Frangible
Input Voltage:	100-240 Vac
Cable:	H07RN-F 3x1, (1,5 meter)
Consumption:	18 Watt /peak

In compliance with

ICAO annex 14

Technical Background

Q Aviation stands for simplicity but high functionality in their products. The Q-Approach Light is the main product of this line of design strategy.

Lighting assemblies

The Q-Approach light can be used for all heliports that are In compliance with ICAO annex 14, volume 2.

The Q-approach light is available in several configurations such as frangible and rigid mounting and 230Vac or 12/24Vdc power supply.

Operation

An approach lighting system should be provided at a heliport where it is desirable and practicable to indicate a preferred approach direction.

The approach lighting system shall be located in a straight line along the preferred direction of the approach.

The steady lights are omnidirectional white LED light.



General dimensions

In the image below the general dimensions and mounting dimensions are displayed.

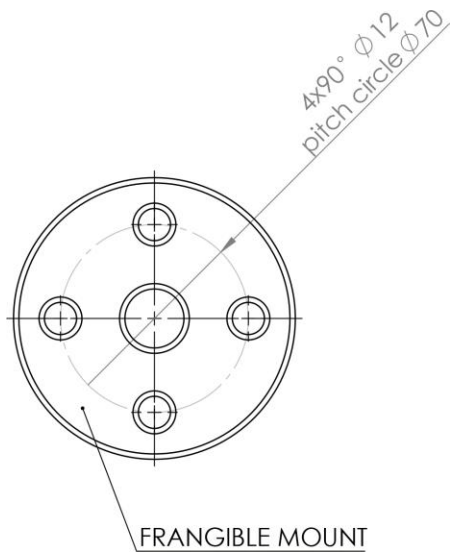
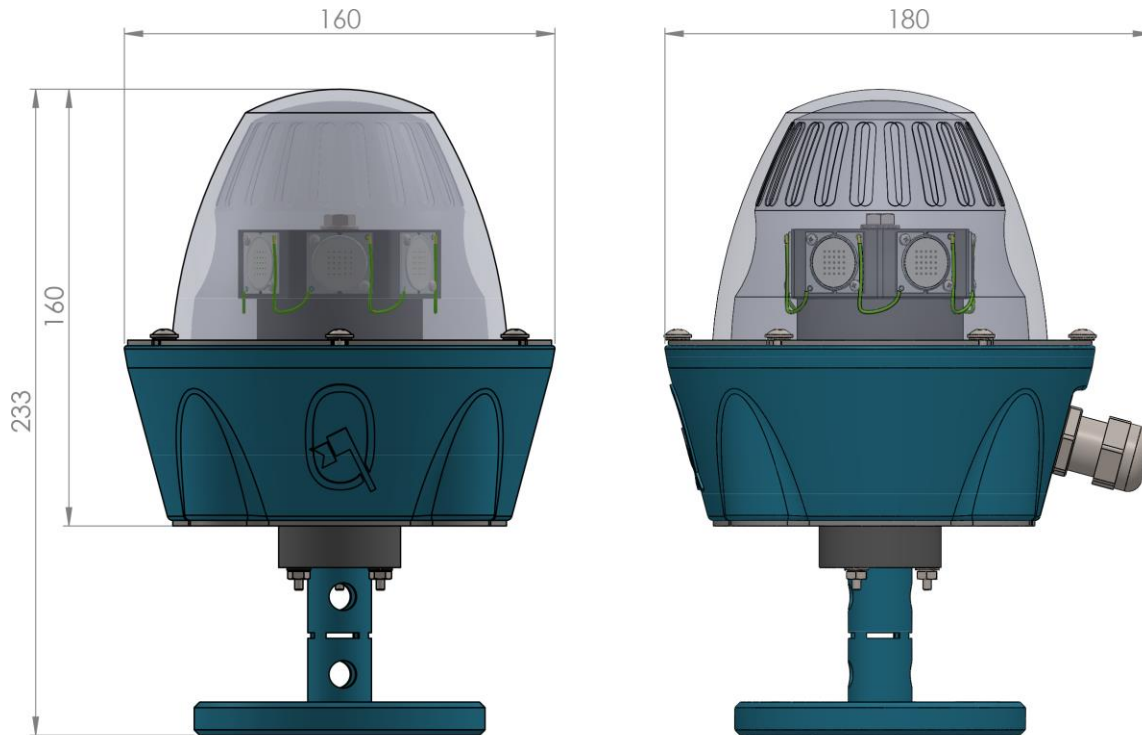

Order codes

The following order codes are available:

Order Code	Configuration
Q1510	Q-Approach Light 100-240 Vac Frangible
Q1512	Q-Approach Light 100-240 Vac Rigid
Q1501	Q-Approach Light 12-24 Vdc Rigid
Q1511	Q-Approach Light 12-24 Vdc Frangible